

## Sri Lankan Embassy Panelling



Panelling from the Sri Lankan Embassy, Swiss Cottage, Regents Park, London.

Installed in the early 1900's, principally oak, with decorative carved elements.  
Raised fielded panels, and several niches and cases, see following pages for detail.  
Available to view at the Walcot yard.

SEE PAGE 2 AND 3 FOR COMPONENTS AND ROOM DIAGRAMS

**Our stock code:** QPROSE-010-011-WAL

**Price:** £25,000.00 + VAT

E. & O. E.

wood flooring / bathrooms & radiators / reclaimed building materials / original fireplaces & interior features / garden ornaments / architectural features

**MASCo Architectural Salvage**

Cirencester Road, Chalford, Stroud, Gloucestershire, GL6 8PE | T. +44 (0)1285 760886 | F. +44 (0)1285 760838 masco@mascosalvage.com www.mascosalvage.com

Reclamation Services Ltd. trading as MASCo Architectural Salvage. Registered in England & Wales No. 1774398

## Sri Lankan Embassy Panelling ROOM ONE

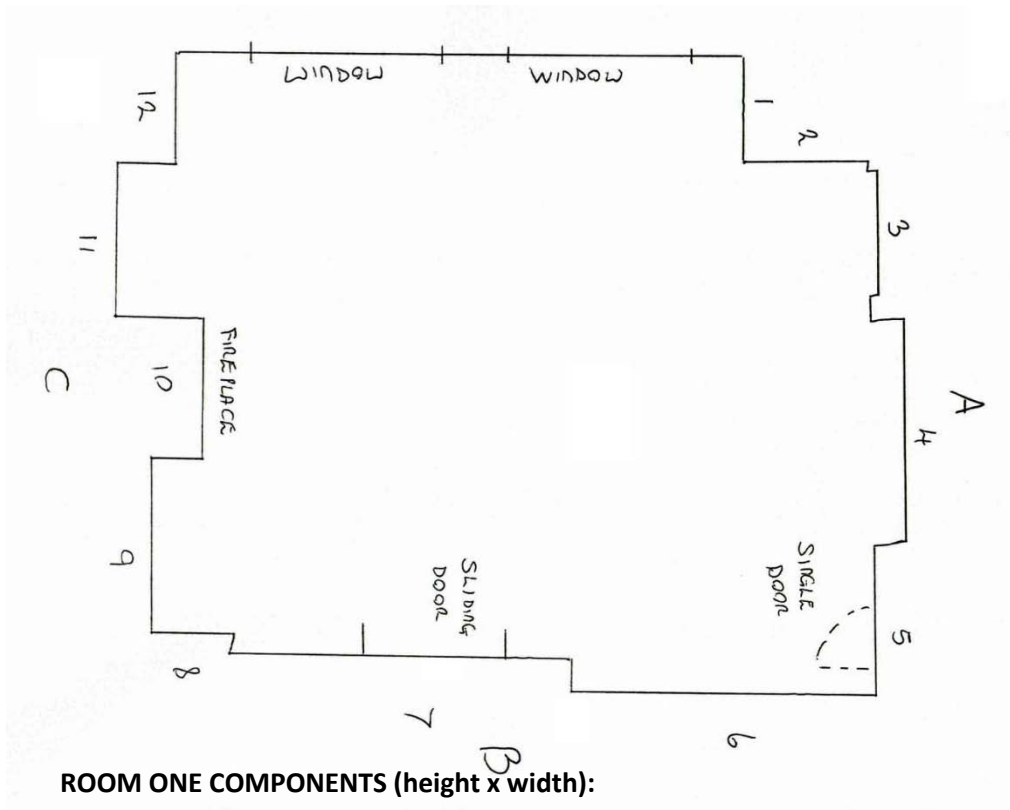

### ROOM ONE COMPONENTS (height x width):

Rm 1 & 2 Sliding Door	2510 x 1600mm	Panel A4	2560 x 210mm
Ceiling Pane D5	2040 x 670mm	Panel A4	2560 x 211mm
Cupboard Door	1520 x 700mm	Panel B4	2560 x 210mm
Cupboard Door	1520 x 705mm	Panel B7	2550 x 1170mm
Door	1850 x 870mm	Panel B8	2540 x 320mm
Door Casement	2550 x 1112mm	Panel B3	2560 x 210mm
Frame A4	2400 x 855mm	Panel C9	2520 x 1290mm
Frame A4	2400 x 840mm	Panel C12	2540 x 1290mm
Panel A3	2560 x 210mm	Panel Return	2540 x 460mm
Panel A4	2540 x 1480mm	Window Reveal	2620 x 840mm

E. & O. E.

wood flooring / bathrooms & radiators / reclaimed building materials / original fireplaces & interior features / garden ornaments / architectural features

**MASCo Architectural Salvage**

Cirencester Road, Chalford, Stroud, Gloucestershire, GL6 8PE | T. +44 (0)1285 760886 | F. +44 (0)1285 760838 masco@mascosalvage.com www.mascosalvage.com

Reclamation Services Ltd. trading as MASCo Architectural Salvage. Registered in England & Wales No. 1774398

## Sri Lankan Embassy Panelling ROOM TWO

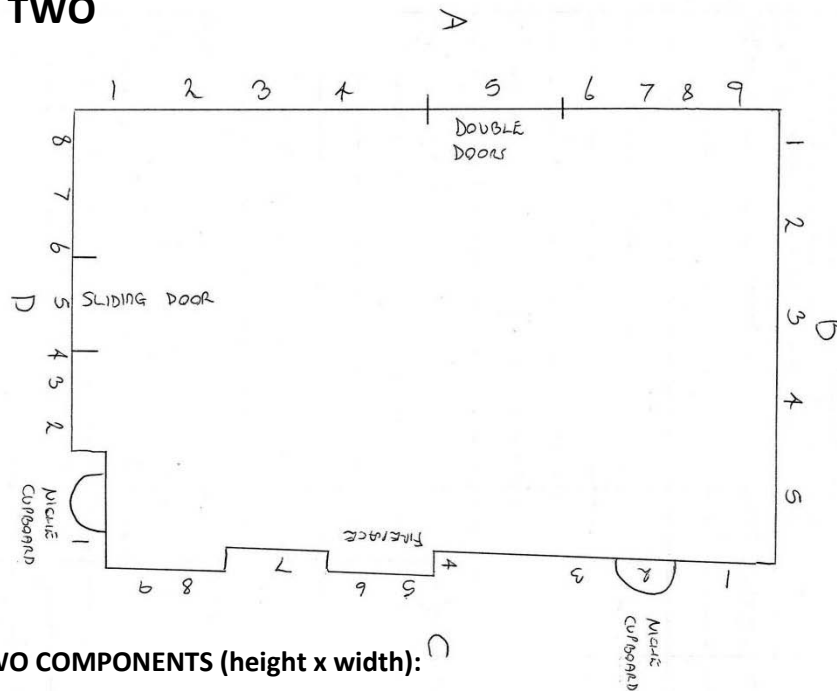

### ROOM TWO COMPONENTS (height x width):

Rm 1 & 2 Sliding Door	2510 x 160mm	Panel A3	2480 x 1610mm
Panel D4	2480 x 290mm	Panel A4	2480 x 290mm
(Double) Door	2010 x 810mm	Panel A6	2480 x 290mm
Ceiling Panel C4-D1	3480 x 700mm	Panel A7	2420 x 1120mm
Cupboard Door C5	680 x 430mm	Panel A8	2460 x 300mm
Cupboard Door C9	680 x 430mm	Panel A9	2420 x 920mm
Cupboard Glass Doors C5 & C9	1690 x 690mm	Panel B1	2460 x 420mm
Door	1960 x 680mm	Panel B3	2460 x 1100mm
Door (Double)	2011 x 810mm	Panel B5	2480 x 420mm
Door Frame A3	2430 x 1220mm	Panel C3	2470 x 770mm
Door Frame A3	2480 x 1610mm	Panel C4	2400 x 680mm
Door Frame A5	2350 x 2000mm	Panel D1	2400 x 680mm
Door Frame B2	2470 x 1750mm	Panel D2	2470 x 320mm
Door Frame C2	2480 x 1750mm	Panel D5	2060 x 2500mm
Door Frame D3	2460 x 1140mm	Panel D5	2460 x 220mm
Fire Surround C10	2550 x 1440mm	Panel D5	2480 x 700mm
Niche Cupboard C5	2340 x 830mm	Panel D6	2480 x 290mm
Niche Cupboard C9	2350 x 830mm	Panel D7	2420 x 1150mm
Over Door Panel A5		Panel D8	2480 x 1150mm
Overmantle C7	1400 x 1380mm	Panel No C1	2480 x 790mm
Panel A1	2470 x 1020mm	Panel No D5	2470 x 720mm
Panel A2	2480 x 290mm	Panel No A1	2430 x 920mm

### E. & O. E.

wood flooring / bathrooms & radiators / reclaimed building materials / original fireplaces & interior features / garden ornaments / architectural features

## MASCo Architectural Salvage

Cirencester Road, Chalford, Stroud, Gloucestershire, GL6 8PE | T. +44 (0)1285 760886 | F. +44 (0)1285 760838 masco@mascosalvage.com www.mascosalvage.com